

Butt 45 Degree Elbows

Elongated

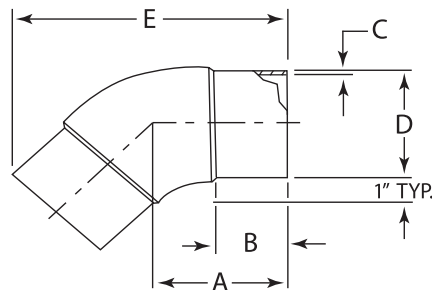

Molded of
PE 100/4710/3408
Black
CODE 113

SDR 17 (Standard Dimension Ratio) 125 PSI (Working Pressure as 73.4 F)

Nominal Diameter (inch)	A (inch)	B (inch)	C (inch) Wall	D (inch) OD	E (inch)	Weight (lbs.)	Product Code	Box Quantities
2" IPS	3.23	2.64	0.14	2.375	6.38	0.23	110 0002 17	20
3" IPS	4.72	3.86	0.206	3.5	9.33	0.72	110 0003 17	6
4" IPS	5.31	4.21	0.264	4.5	10.63	1.32	110 0004 17	3
6" IPS	6.89	5.35	0.39	6.625	14.09	3.77	110 0006 17	4
8" IPS	8.46	6.54	0.508	8.625	17.48	8.03	110 0008 17	1
10" IPS	10.04	7.64	0.633	10.75	20.94	14.44	110 0010 17	2
12" IPS	10.63	7.8	0.75	12.75	22.64	21.3	110 0012 17	1

SDR 11 (Standard Dimension Ratio) 200 PSI (Working Pressure as 73.4 F)

Nominal Diameter (inch)	A (inch)	B (inch)	C (inch) Wall	D (inch) OD	E (inch)	Weight (lbs.)	Product Code	Box Quantities
¾" IPS	2.28	2.05	0.095	1.05	4.29	0.05	110 0075 11	40
1" IPS	2.48	2.17	0.119	1.315	4.69	0.08	110 0001 11	30
1¼" IPS	2.83	2.44	0.151	1.66	5.31	0.14	110 0125 11	15
1½" IPS	3.07	2.64	0.173	1.9	5.91	0.21	110 0150 11	25
2" IPS	3.23	2.64	0.216	2.375	6.38	0.35	110 0002 11	20
3" IPS	4.72	3.86	0.318	3.5	9.33	1.07	110 0003 11	6
4" IPS	5.31	4.21	0.409	4.5	10.63	2	110 0004 11	3
6" IPS	6.89	5.35	0.603	6.625	14.09	5.55	110 0006 11	4
8" IPS	8.46	6.54	0.785	8.625	17.48	11.64	110 0008 11	1
10" IPS	10.04	7.64	0.978	10.75	20.94	21.3	110 0010 11	2
12" IPS	10.63	7.8	1.16	12.75	22.64	31.84	110 0012 11	1